

Zorro 2

LED Area and Pathway Luminaire



Installation Instructions



NOTE: All electrical work must be carried out by a licensed electrician as per the latest AS 3000 wiring regulations. The light must be operated within its specified operating parameters and in accordance with our warranty requirements. These documents are available on our website.

INSTALLATION

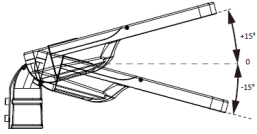

Loosen the bolts on the mounting bracket and adjust tilt angle as desired. The tilt angle can be adjusted from -15° to $+15^{\circ}$ in steps of 5° (tilt indicator circled in red). Tighten bolts (17Nm) to secure.

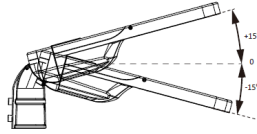

For vertical mount turn the bracket 180 degrees, select the desired tilt angle and tighten bolts (17Nm) to secure.

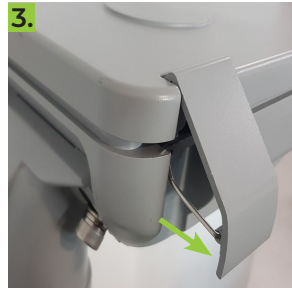

Unclip the buckles to open housing.

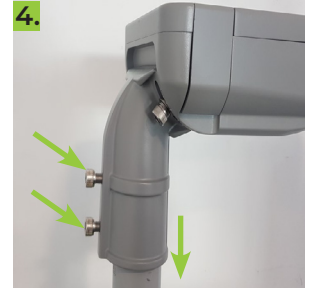

Feed cable into light fitting, slip pole adaptor over pole and secure by tightening the bolts to 17 Nm. Do not overtighten.

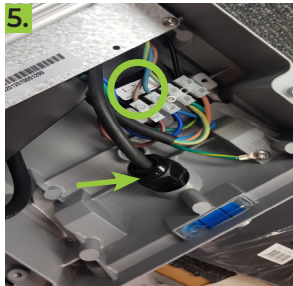

Connect mains wires to terminal block. Tighten cable gland.

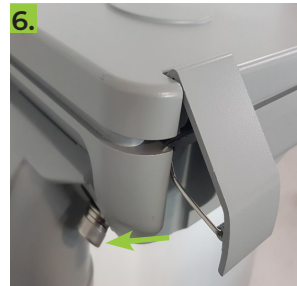

Close housing and clip buckles to secure.

MOUNTING ADAPTORS

Double arm adaptor (ZWB-CrossArm)

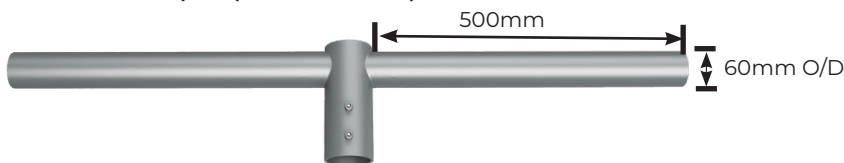

Arms 500mm long, 60mm O/D. Fits round pole 76mm O/D

Zorro 2

LED Area and Pathway Luminaire



Installation Instructions

Pole Reducer (ZWB-PoleRed)



Fits round poles 76mm O/D

40-60mm adaptor (ZWB-ConAdap)



Increases the size of a 42mm diameter pole to a 60mm diameter pole

Wall mount (ZWB-15 Degree)



Allows wall mounting a Zorro 2 luminaire. Spigot diameter 60mm. Spigot is angled 15 degrees upwards.

DIMENSIONS

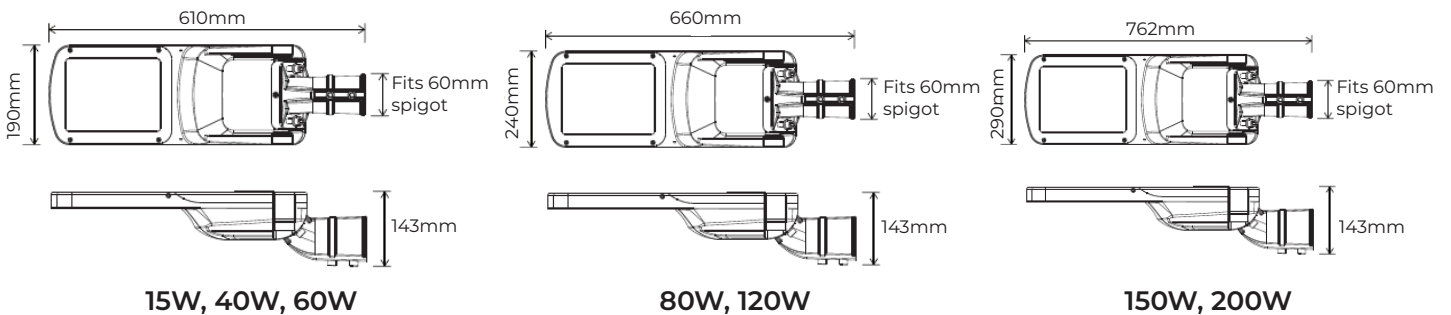

15W, 40W, 60W

80W, 120W

150W, 200W

Key Luminaire Specifications				
Model	Version	Power Rating	Ambient Temperature	Weight
ZAL15	Zorro 2 15W	200-240VAC 50/60Hz, 15W	-40 - +50°C	4.7kg
ZAL40	Zorro 2 40W	200-240VAC 50/60Hz, 40W	-40 - +50°C	4.7kg
ZAL60	Zorro 2 60W	200-240VAC 50/60Hz, 60W	-40 - +50°C	4.7kg
ZAL80	Zorro 2 80W	200-240VAC 50/60Hz, 80W	-40 - +50°C	5.8kg
ZAL120	Zorro 2 120W	200-240VAC 50/60Hz, 120W	-40 - +50°C	5.8kg
ZAL150	Zorro 2 150W	200-240VAC 50/60Hz, 150W	-40 - +50°C	8.1kg
ZAL200	Zorro 2 200W	200-240VAC 50/60Hz, 200W	-40 - +50°C	8.1kg